



Revision 2025-08

# EZ Centrifuge Quick Reference Guide

Cat. No.: 118100700



## Features:

- ▶ Compact design for quick spin-downs with rapid acceleration
- ▶ Wide tube capacity for various microtubes and PCR strips
- ▶ Simple lid-press activation, reaching up to 6,000 rpm

## Packing list

- ▶ EZ Centrifuge Main Unit x 1
- ▶ AC Adapter x 1
- ▶ Quick Reference Guide x 1

## Installation & Setup

- 1 Place the EZ Centrifuge on a stable workbench, connect it to the power supply, and switch on the main power.
- 2 Insert the microcentrifuge tubes into the rotor cavities, ensuring they are balanced.
- 3 Close the lid securely and the centrifuge will automatically start the spin cycle.
- 4 To stop, press the unlock button. Once the rotor has fully stopped, open the lid and retrieve your tubes.

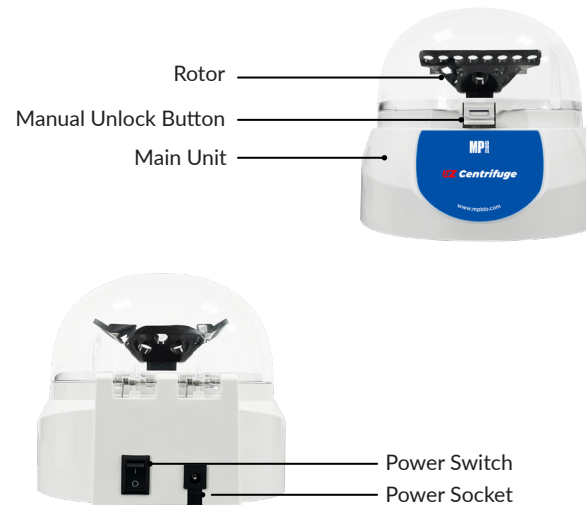

## Safety Precautions

- ▶ Never touch the power socket or power switch with wet hands.
- ▶ Never unplug the power cord while the instrument is turned on.
- ▶ Do not perform maintenance, cleaning, or wipe-down procedures while the instrument is connected to a power source.

## Specification

- ▶ Rotor Capacity:  
6 x 2 mL / 6 x 1.5 mL / 6 x 0.5 mL / 16 x 0.2 mL centrifuge tubes, or 2 x 8-tube PCR strips
- ▶ Maximum Speed: 6,000 rpm
- ▶ Power: 100 - 240V
- ▶ Weight: 1.6 KG
- ▶ Dimension: 156 x 183 x 130 mm



Scan the QR code here to  
view the product



# More Sample Preparation Solutions

## FastPrep® Family

High-speed bead beating for rapid, efficient sample homogenization and disruption



Wide variety of lysing matrices for specific sample types and applications, ensuring complete homogenization.



Lysing Matrix A

Lysing Matrix B

Lysing Matrix C

Lysing Matrix D



Lysing Matrix E

Lysing Matrix F

Lysing Matrix G

Lysing Matrix H

## SPINeasy Nucleic Acid Purification Kits

Simplified spin column-based extraction for fast, reliable nucleic acid purification.



Scan here to see the full catalogue



## Automated Nucleic Acid Purification (aNAP) System

Efficient, high-purity nucleic acid isolation with advanced magnetic bead technology.



Scan here to see the full catalogue



VISIT US AT  
[www.mpbio.com](http://www.mpbio.com)

**MP** AMERICAS: 800.854.0530 | [biotech@mpbio.com](mailto:biotech@mpbio.com)  
APAC: +65 6775 0008 | [custserv.ap@mpbio.com](mailto:custserv.ap@mpbio.com)  
EUROPE: 00800.7777.9999 | [techsupport.eur@mpbio.com](mailto:techsupport.eur@mpbio.com)



[www.mpbio.com](http://www.mpbio.com)